

# INSTALLATION INSTRUCTIONS

## Troldekt® Plus K0, K5 and K11, installed with screws

These instructions apply to installation of Troldekt® Plus K0, K5 and K11 with screws on wooden battens or steel profile system. Please note that Troldekt® Plus comes in two different variants with two different backing layers – Troldekt® Plus mineral wool and Troldekt® Plus Stratocell. If you install Troldekt® on wooden battens, the battens should be minimum 22x95 mm. You can download installation instructions for the Troldekt® C60 profile system or wooden battens from [www.troldekt.com](http://www.troldekt.com).

### PROFILE DRAWINGS (INDEPENDENT OF SUSPENSION)

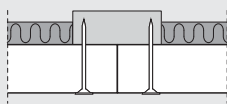

K0 Troldekt Plus  
Square edges

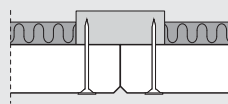

K5 Troldekt Plus  
With 5 mm bevel

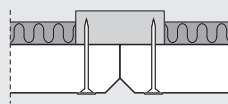

K11 Troldekt Plus  
With 11 mm bevel

K0, K5 and K11 are available as Troldekt Plus in the following panel thicknesses:

**25+18 / 25+40 / 35+18 / 35+40 mm**

(Note: 25+40 / 35+40 mm cannot be combined with a C60 profile system)

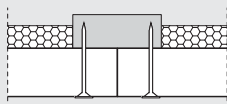

K0 Troldekt Plus Stratocell  
Square edges

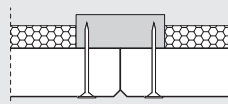

K5 Troldekt Plus Stratocell  
With 5 mm bevel

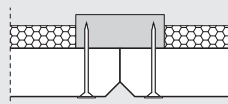

K11 Troldekt Plus Stratocell  
With 11 mm bevel

K0, K5 and K11 are available as Troldekt Plus Stratocell in the following panel thicknesses:

**25+20 / 25+40 / 35+20 / 35+40 mm**

(Note: We only recommend Troldekt Plus Stratocell for direct installation)

### INSTALLATION (PLEASE READ FULL INSTRUCTIONS BEFORE STARTING WORK)

**1:** Start by installing a complete row of Troldekt panels along the centre line of the room. Then continue on both sides. It is important that the panels are installed closely together, and the optimum aesthetic effect is obtained by installing the panels in broken bond.

**2:** Fix the panels using Troldekt screws spaced 25/20 mm from the edges – as indicated in the figure below. 25 mm for wooden battens, 20 mm for C60 steel profiles. Be careful not to overdrive the washered screws and so cause an indentation in the panel.

**Note:** When installing **600x600 mm** square panels, it is important to ensure that the wood wool fibres run mainly parallel in one direction. To ensure a uniform appearance, install the panels so that the printed Troldekt texts on the back of the panels all run in the same direction.

### ILLUSTRATION – INSTALLATION, K0, K5 AND K11

The figure shows longitudinal wooden battens, but transverse battens are equally applicable. Note, however, the tolerances of the Troldekt panels. If the panels are very dry, they could be undersized, which could cause problems on very large surfaces with transversal wooden battens.

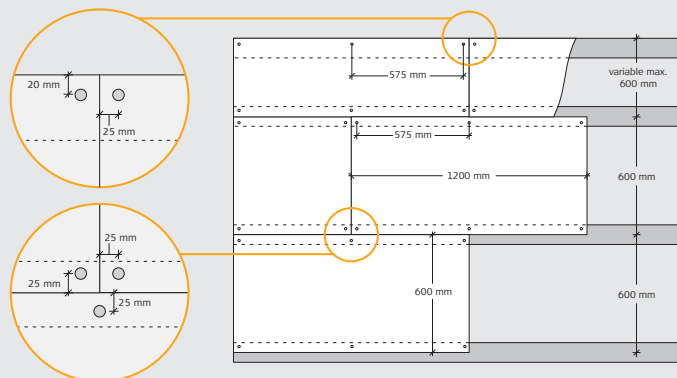

## VAPOUR CHECK

If you need to install a vapour check, we recommend using polyethylene. The vapour check must be placed over the wooden battens, i.e. between the battens and the main beam. Install the vapour check tightly against the insulation.

Please refer to the manufacturer's instructions.

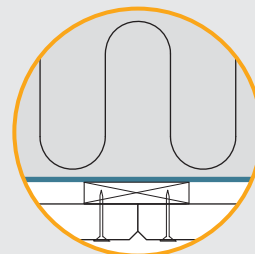

## TROLDTEKT® SCREWS

Panel thickness (mm)	Panel length (mm)	Screw dimension (mm)	No. of screws (per panel)	Max. span (mm)
25 / 25+18 / 2540	600	4,2x45	4	600
	1200		6	
	2000/4000		10	
35 / 35+18 / 35+40	600	4,2x55	4	600
	1200		6	
	2000/2400		10	

Troldtekt structure screw for wood and steel, PH2

